

SCU Ivian Series Service Over Counter with Sliding Doors



BENEFITS AT A GLANCE

- Ordinary front panel cover, simple and premium, convenient for customers' renovation
- Crash bar options: stainless steel or aluminum alloy
- Horizontal sliding glass doors, smoother sliding for corner counters
- Light covers are integrated with the rear sliding door frame to improve permeability
- The large size of the exterior corner counter is convenient for various layouts and form a perfect "S" shape with interior corner counters
- Rectangular, curved glass/plug-in, remote options to meet different user needs



| Standard Model | Remote Service Over Counter with Sliding Doors/ Service Over Beef Case | Remote Service Over Counter with Sliding Doors Corner Counter/ Service Over Corner Beef Case | Remote Arc-shaped Service Over Counter with Sliding Doors Service Over Beef Case | Plug-in Arc-shaped Service Over Counter with Sliding Doors | Remote Arc-shaped Service Over Corner Counter with Sliding Doors Service Over Corner Case | Arc-shaped Dry Heating Counter with Sliding Doors | |
|------------------------------------|--|--|--|--|---|---|------------------|
| | SCU 063/094 / 125/188/250/375 75 R T / M | SCU EC90 75 R T / M | SCU 063/094/ 125/188/250/375 75 R T C/ M | SCU 125/188/ 250/375 75 P T C | SCU EC90 75 R T C/ M-3L | SCU 188 75 R T C | SCU 250 75 R T C |
| Dimensions (Width) | 625/ 937/ 1250/ 1875/ 2500/ 3750 | 1650 | 625/ 937/ 1250/ 1875/ 2500/ 3750 | 1340/1965/ 2590/3840 | 1650 | 1875 | 2500 |
| Dimensions (Depth) | 1055 | 1650 | 1055 | 1055 | 1650 | 1055 | 1055 |
| Dimensions (Height) | 1160 | | | | | | |
| Operation Temperature (°C) | -1-5 | 3-8 | -1-5 | -1-5 | 3-8 | 40-60 | 40-60 |
| Temperature Grade | 3 M1 | 3 S | 3 M1 | 3 M1 | 3 S | / | / |
| Rated Voltage (V) | 220V | | | | | | |
| Rated Frequency (Hz) | 50Hz | | | | | | |
| Net Weight (kg) | 110/ 150/ 190/ 270/ 335/ 490 | 340 | 110/ 150/ 190/ 270/ 335/ 490 | 220/295/365/525 | 340 | 270 | 335 |
| Display Area (m ²) | 0.40/ 0.61/ 0.81/ 1.22/ 1.62/ 2.43 | 1.27 | 0.31/ 0.47/ 0.63/ 0.94/ 1.26/ 1.89 | 0.31/ 0.47/ 0.63/ 0.94/ 1.26/ 1.89 | 1.06 | 0.94 | 1.26 |
| Effective Volume (m ³) | 0.07/ 0.11/ 0.15/ 0.22/ 0.30/ 0.44 | 0.20 | 0.07/ 0.11/ 0.14/ 0.21/ 0.29/ 0.43 | 0.07/ 0.11/ 0.14/ 0.21/ 0.29/ 0.43 | 0.21 | 0.21 | 0.29 |
| Energy Efficiency Level (EEL) | Grade 2 | / | Grade 2 | Grade 2 | / | / | / |

CONFIGURATION OPTIONS (STANDARD)

- Support legs: sheet metal legs
- Material options for bottom partition, return air grilles and back panel: powder coating
- Crash bar options: aluminum alloy
- Heat pipes of evaporator: without heat pipe
- Controller options: Carrier standard refrigeration controller unit*
- Evaporator blower fan options: EBM Q motor*
- Evaporator Expansion Valve options: Carrier R404A evaporator expansion valve*
- Front and rear sliding door color: black
- Lights: T8 energy-saving integrated LEDs 6500K

DIMENSION DRAWING

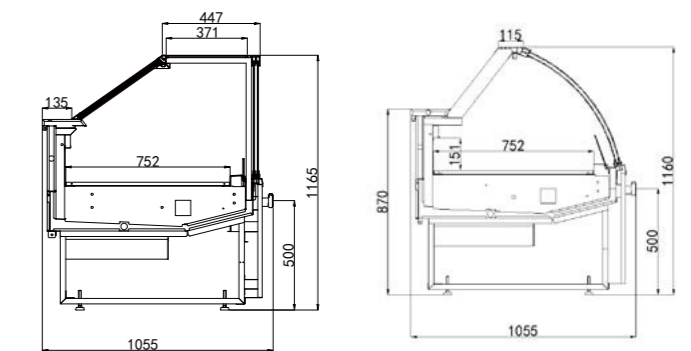

SCU Ivian Series Service Over Counter with Sliding Doors

SCU Ivian Series Service Over Counter with Sliding Doors

NOMENCLATURE

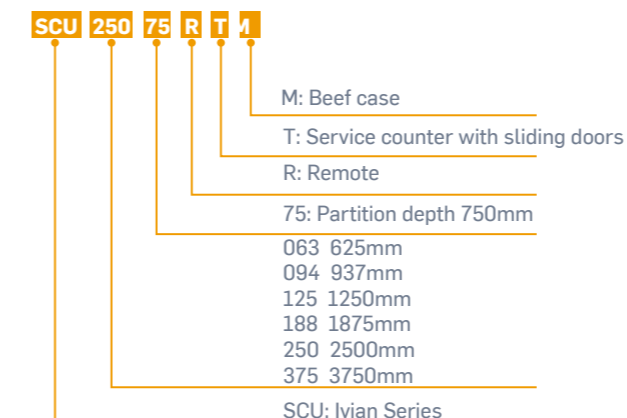

Equivalent brand products can be replaced. For more optional information, please refer to page 63.